

Mark C. McConnell
Deputy Executive Director/
Chief Engineer

Lisa M. Hancock
Deputy Executive Director/
Administration



Melinda L. McGrath
Executive Director

Dick Hall
Central District Commissioner

J. Kevin Magee
District 3 Engineer

David Foster
District 5 Engineer

P. O. Box 90 / Newton, MS 39345-0090 / Telephone (601) 683-3341 / FAX (601) 683-7030 / GoMDOT.com

April 20, 2015

Mr. Carl Banks
President, Madison County Board of Supervisors
P. O. Box 608
Canton, Mississippi 39046

RE: Permit No. 171/14
State Route 22/State Route 463
Madison County

Dear Mr. Banks:

Attached for execution by the Madison County Board of Supervisors (Board), please find Permit No. 171/14 that was previously issued to Livingston Township Fund #1 (Livingston). Transfer of this permit to the Board is at the request of Livingston (copy attached).

It is the understanding of the District that the Board is receptive to the transfer of the permit and by executing same will abide by all conditions and requirements stated therein. Please know that transfer of the permit is in its entirety as originally permitted to Livingston. Madison County will be responsible for all work performed to date, as well as items yet to be completed.

In closing, please know that Permit No. 171/14 signed by the Madison County Board of Supervisors must be received at the Newton District Office prior to the County, or its designee, performing any work associated with the permit.

If this office can be of any assistance, please contact me at the Newton District Office (601-683-3341).

Sincerely,

DAVID FOSTER, P.E.
DISTRICT ENGINEER

DF:vv
Attachments

Mr. Carl Banks
April 20, 2015
Page 2
Permit No. 171/14

pc: Commissioner Dick Hall
Mr. Mark McConnell, Chief Engineer/Deputy Executive Director
Mr. Michael C. Bollenbacher
Mr. Rudy Warnock, Madison County Engineer
Mr. Roy May, Asst. District Engineer-Maintenance
Mr. Marty Hollingsworth, Branch Director II (Permits)
Mr. Michael Lang, H. D. Lang & Associates, Inc.
Mr. Neil Patterson, Resident Engineer
Mr. Andy Taggert, Esq.

LIVINGSTON TOWNSHIP FUND #1, LLC
 116 Livingston Church Rd. Suite B
 Flora, MS 39071
 FAX (626) 800-1209

February 17, 2015

Mississippi Department of Transportation
 Division 5. Attn: David Foster
 7759 Hwy 80W
 Newton, MS 39345
 RE: Permit # 171/14

HWY 463/22

FIFTH DISTRICT				
REC'D	FOR	INF	ACTN	DATE
	FOSTER	DF		2/19
	ADDY			
	BARNETT			
	CAMPBELL			
	CASTILLO			
	CLARKE			
	CLEVELAND			
	COPELAND			
	EVANS			
	GRANER			
	GRANTHAM			
	HOLLINGSWORTH			
	LEE			
	LOVELL			
	MAY, ROY			
	MCDONALD			
	McMULLAN			
	MORGAN			
	RAINEY			
	REEVES			
	SMITH			
	STOKES			
	J. THORNE			
	S. THORNE			
	TRIPLETT			
	WEDGEWORTH			
	WILLIAMS			

Dear Mr. Foster,

Livingston Township Fund #1 respectfully requests the transfer of the above noted permit to the County of Madison, Attn: Rudy Warnock. I have requested that Mr. Warnock forward to you a letter asking that the permit be transferred to the County.

Please let us know what other documentation you need to complete this transfer. My email address is mike@arroyodevelopment.com or I can be reached on my cell phone at 818 631-0389.

Many Thanks,

Sincerely,



Michael C. Bollenbacher

CC: Rudy Warnock, Madison County Engineer
 Michael Lang, HD Lang Engineering
 Andy Tagger, Esq

Mark C. McConnell
Deputy Executive Director/
Chief Engineer

Lisa M. Hancock
Deputy Executive Director/
Administration



Melinda L. McGrath
Executive Director

Dick Hall
Central District Commissioner

J. Kevin Magee
District 3 Engineer

David Foster
District 5 Engineer

P. O. Box 90 / Newton, MS 39345-0090 / Telephone (601) 683-3341 / FAX (601) 683-7030 / GoMDOT.com

April 17, 2015

NOTARIZATION REQUIRED
THIS IS NOT AN APPROVED PERMIT

Madison County Board Of Supervisors
125 West North Street
Canton, MS 39046

RE: Permit # 171/14

Dear Sir:

Enclosed please find FORM MND-001, application for permit for construction of a driveway with connection to state highway and agreement of applicant given in consideration of such permit, covering your proposed driveway to a future development with connection to Hwy. 22 and Hwy 463 between Canton and Flora in Madison County, as submitted by you.

Your attention is called to page 3 of the permit application. **DO NOT** sign this page at this time. When all work has been completed, you are then requested to sign and return this form to the Permit Department.

You will, of course, understand that this plan, as yet, is **NOT** your permit and cannot be processed further until you have this plan notarized. Therefore, if this plan meets with your approval, SIGN THIS APPLICATION BEFORE A NOTARY PUBLIC AND RETURN ALL PAGES OF THE EXECUTED APPLICATION TO THIS OFFICE AT YOUR EARLIEST CONVENIENCE.

If you have any questions please call the District Permit Office at (601) 683-3771.

Very Truly Yours,

DAVID FOSTER, DISTRICT ENGINEER

BY: Marty Hollingsworth

Marty Hollingsworth
Branch Director II

Attachments
MH:mh

Applicant Contact Name: Madison County Board of Supervisors
Applicant Contact Phone #: 601-855-5500

**MISSISSIPPI DEPARTMENT OF TRANSPORTATION
APPLICATION FOR PERMIT TO CONSTRUCT DRIVEWAY WITH
CONNECTION TO STATE HIGHWAY AND AGREEMENT OF APPLICANT
GIVEN IN CONSIDERATION OF SUCH PERMIT**

(Please Print) Name: Madison County Board of Supervisors Address: 125 West North Street
Company (or) Individual Street/Route
Canton Madison MS 39046
City County State Zip Code

herein called the applicant, who at the present time proposes to construct a driveway connecting a proposed development
_____ with Highway No. 22 & 463
between Canton and Flora
Latitude (decimal degrees) 32.553180 Longitude (decimal degrees) -90.21738

in Madison County, Mississippi, does hereby make application to the Mississippi Department of Transportation, the duly authorized agent for the Mississippi Transportation Commission, for permission to construct the said driveway mentioned above and shown herein below and in consideration of a permit being granted to me for such construction, do hereby agree to construct such facility in accordance with the plan shown herein below and the rules and regulations of the Mississippi transportation Commission and do also further agree, with full understanding of the terms thereof, to all of the following:

- (a) That the Mississippi Department of Transportation does not purport to grant to said applicant any right, title, claim or easement in or upon said highway or right-of-way appurtenant thereto.
- (b) That the said Mississippi Department of Transportation may at any time require and compel the removal or reconstruction of said driveway or other facility therein described or referred to, as and when said Mississippi Department of Transportation deems it necessary. All expense of said removal or reconstruction is to be borne exclusively by the applicant and the Mississippi Department of Transportation is to be in no way liable.
- (c) Said applicant hereby expressly agrees for himself, his heirs, assigns and legal representatives, that upon request of said Mississippi Department of Transportation, he will without delay either reconstruct, remove or move to another location the facility herein described all in accordance with the terms of the request so made by the said Mississippi Department of Transportation. It being distinctly understood that said that any other location for said facility or driveway shall be primarily the choice of said Mississippi Department of Transportation but said new location will be made or designated by said Mississippi Department of Transportation after agreement with said applicant or is successors, if possible. It is understood and agreed that the Mississippi Department of Transportation, if this permit is granted and acted upon by the said applicant, will use all reasonable effort to avoid the necessity of requesting that the herein mentioned facility be removed, altered or reconstructed.
- (d) The plan of proposed construction set out below is incorporated herein by reference and made a part of this application as if fully copied out herein in words and figures.
- (e) It is agreed that this permit is void if all work shown on this plan is not completed in accordance with this plan within one year after date of approval.
- (f) It is agreed that any gas pumps at this location will be so placed that they or their island or islands will be a minimum of 12 feet behind the right of way line.
- (g) It is distinctly understood that no cars or vehicles will be parked or serviced within the limits of the highway right of way.
- (h) Pipe culverts shall comply with the Department's "MDOT PIPE CULVERT MATERIAL DESIGN CRITERIA", LATEST VERSION. (Reference: MDOT Website 'www.goMDOT.com'). Pipe headwalls, box culverts, bridges, inlets, junction boxes, headwalls, grates, etc. shall be designed, detailed and constructed in accordance with the Department's Roadway and Bridge Design Manuals and Standard Drawings and Mississippi Standard Specifications for Road and Bridge Construction.
- (i) The applicant is responsible for any conflicts with utilities on the highway right-of-way and is to secure permission from said utilities for said conflicts and for any necessary alterations.
- (j) Any work done by the applicant on the highway right-of-way shall be at his sole expense and may be utilized by the Mississippi Department of Transportation without payment thereof.
- (k) A copy of the approved plan is to be kept at the site of the work at all times during construction.
- (l) It is agreed that no trees or shrubs on the highway right-of-way will be cut, trimmed, or damaged during the process of the proposed work or maintenance of this work or facility except as shown on the plan.
- (m) All sod disturbed by the proposed work shall be neatly dressed and grassed in accordance with the vegetation schedule outlined elsewhere in this permit. The applicant shall maintain the dressed and grassed area for a sufficient length of time to insure a growing sod.

FAILURE TO COMPLY WITH THIS PLAN AUTOMATICALLY CANCELS THIS PERMIT.

- (n) The applicant accepts the responsibility of the safety of the traveling public and his/her workers and agrees to furnish, place and maintain traffic control devices, if required, in accordance with Part 6 of the Manual On Uniform Traffic Control Devices For Streets and Highways (MUTCD), Current Edition as a minimum. The applicant shall attach a special traffic control plan to the application if special traffic control details are required.
- (o) The applicant does hereby covenant and agree to indemnify and hold harmless the Mississippi Transportation Commission and the Mississippi Department of Transportation from and against any claims, actions, suits, causes or demands, including court costs and reasonable attorney's fees, proximately resulting from acts or omissions of the applicant, or applicant's servants, agents or employees in the construction and maintenance of all facilities outlined under this permit.

Witness my signature this _____ day of _____ 20_____, which is applicable to sheets 1
through _____ of permit number _____.

Signature of Applicant

By: _____
Printed Name and Title

STATE OF MISSISSIPPI
COUNTY OF _____

Personally appeared before me, the undersigned authority, _____ whose
Printed Name of Applicant

names(s) _____ subscribed to this instrument as the _____ of
is/are _____ Title of Applicant

_____ who having been first fully sworn acknowledged that they
Name of Company (or) Individual

executed the above agreement as the act and deed of the said applicant for the purpose and consideration and in the capacity therein expressed and on the date above written.

Given under my hand and seal of office this the _____ day of _____ 20_____

My Commission Expires: _____
Signature of Notary Officer

Field Inspection By: _____ 20_____

Approved: MISSISSIPPI DEPARTMENT OF TRANSPORTATION

Mark McConnell
Deputy Executive Director/Chief Engineer

By: _____ 20_____
David Foster, District Engineer

Installation Inspection By: _____ 20_____

Mississippi Department of Transportation
Completion of Work Certification

This permit requires that the named applicant submit the following certification with signature(s) and insure proper filing with MDOT's District Permit Department before the permit is closed and all associated bonds are released:

Permit Representative's signature(s) acknowledges the following:

We/(I), certify that the requirements of this permit have been constructed as stated in the approved final permit. Furthermore, no work performed as an exercise of the approved permit, has been relocated or altered without such change being shown on an approved revision of the permit or approved addenda thereto.

Printed Name of Applicant

Signature of Applicant

Supplement to:
MND-001
MND-002
MND-004

MISSISSIPPI DEPARTMENT OF TRANSPORTATION

MND-005
Rev. 2-95



ShowNorth

REVISIONS		APPLICANT	MDOT
DATE	BY	DATE	BY
07/21/14	JBH		
09/16/14	JBH	9-17-14	MH

Sheet No.: 3 of 14

Permit No.: 171/14

Scale 1"=300'

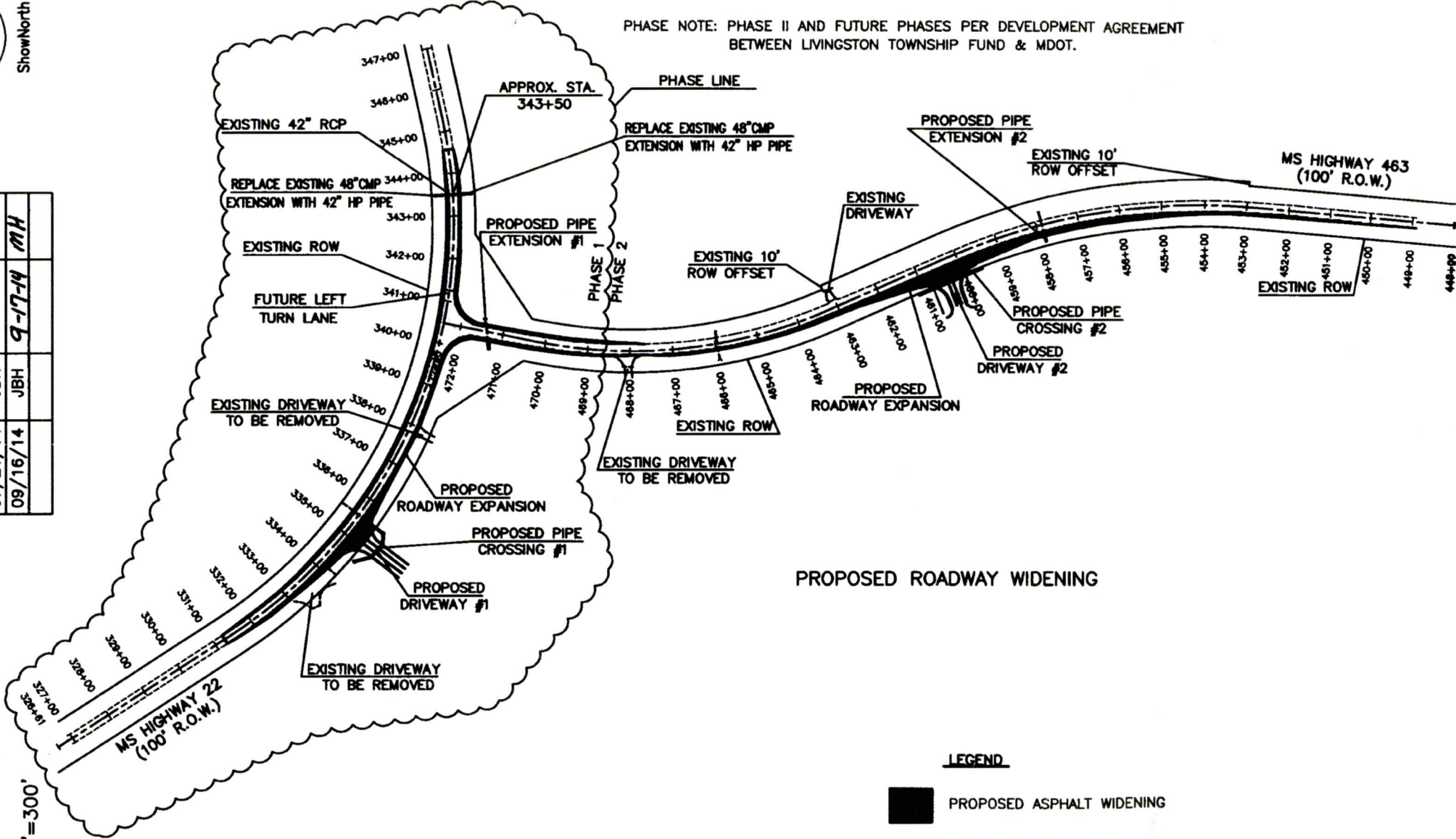

PHASE NOTE: PHASE II AND FUTURE PHASES PER DEVELOPMENT AGREEMENT BETWEEN LIVINGSTON TOWNSHIP FUND & MDOT.

PROPOSED ROADWAY WIDENING

LEGEND

- PROPOSED ASPHALT WIDENING
- EXISTING EDGE OF PAVEMENT
- CENTERLINE OF ROADWAY

Supplement to:
 MND-001
 MND-002
 MND-004

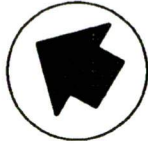

Show North

MISSISSIPPI DEPARTMENT OF TRANSPORTATION

REVISIONS			APPLICANT	MDOT
DATE	BY	DATE	BY	BY
06/20/14	JBH			
07/16/14	JBH			
07/21/14	JBH			

Sheet No.: 4 of 14

Permit No.: 17114

Scale 1"=300'

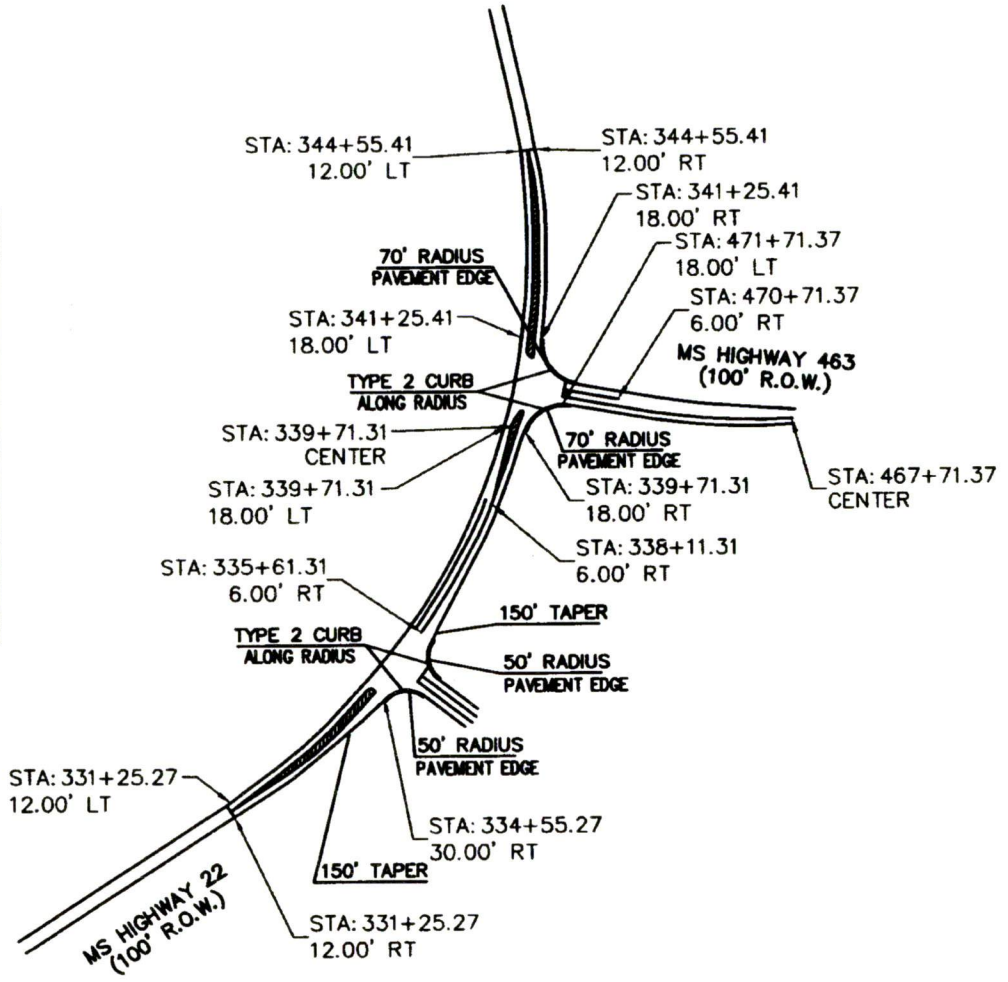

PROPOSED LEFT TURN LANE ADDITIONS

CURB AND GUTTER NOTE:
 INTERSECTION RADIUS SHOWN ON PLAN
 SHALL BE TYPE 2 CURB ALONG THE
 THE RADIUS.

MND-005
 Rev. 2-93

Supplement to:
MND-001
MND-002
MND-004



ShowNorth

MISSISSIPPI DEPARTMENT OF TRANSPORTATION

MND-005
Rev. 2-93

REVISIONS		MDOT	
APPLICANT	BY	DATE	BY
	JBH	06/20/14	
	JBH	07/21/14	

Sheet No.: 5 of 14

Permit No.: 11114

Scale 1"=300'

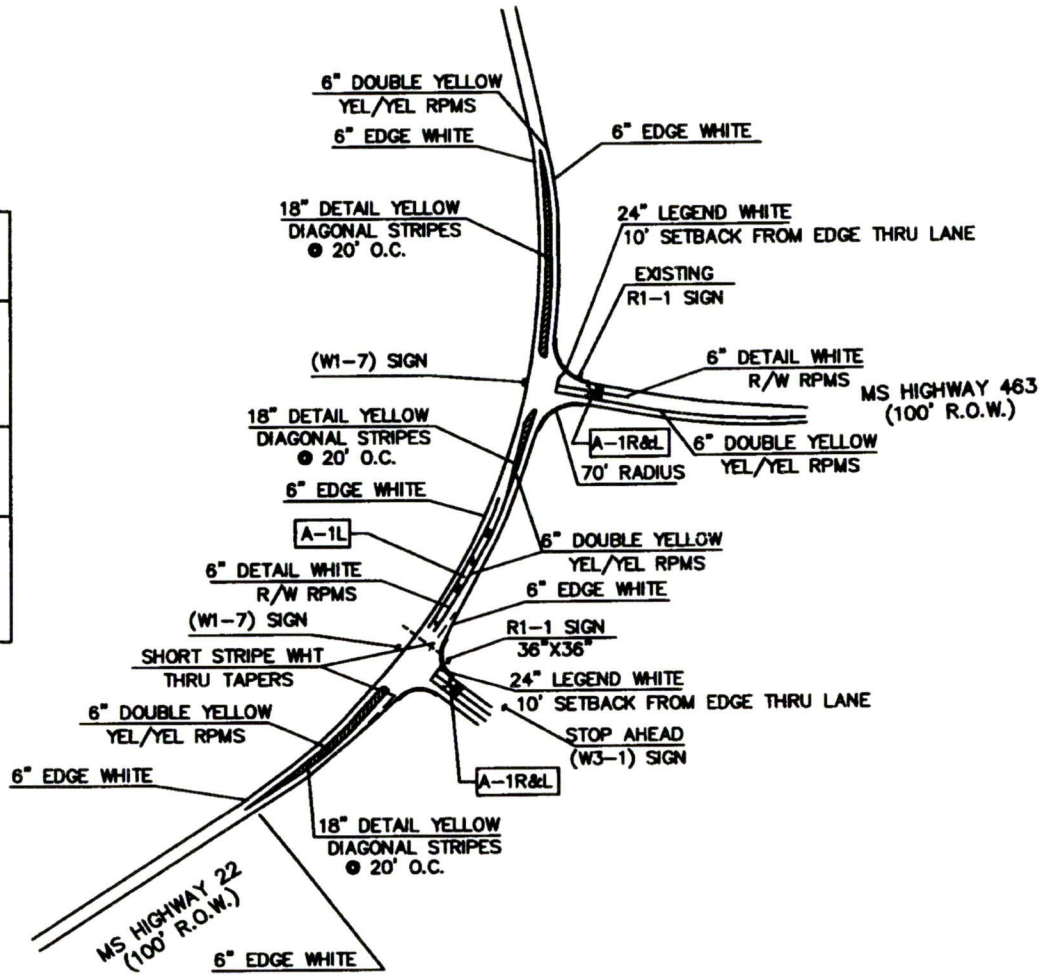

PROPOSED STRIPING AND SIGNS

NOTES:

- EXISTING SIGNS IN PROJECT AREA TO REMAIN AND MAY NEED TO BE RELOCATED AND RESET IF SIGN IS INSIDE WIDENING AREA.
- ALL PAVEMENT MARKINGS SHALL BE THERMOPLASTIC.

LEGEND

R/W RPMS
YEL/YEL RPMS

RED/WHITE RAISED PAVEMENT MARKERS
YELLOW/YELLOW RAISED PAVEMENT MARKERS



A-1L DETAIL

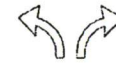

A-1R&L DETAIL

Sheet No.: _____ of _____
 Permit No.: 1111/14
 Scale 1" = 300'

REVISIONS			
APPLICANT	BY	DATE	MDOT
	JBH	8-19-14	MH

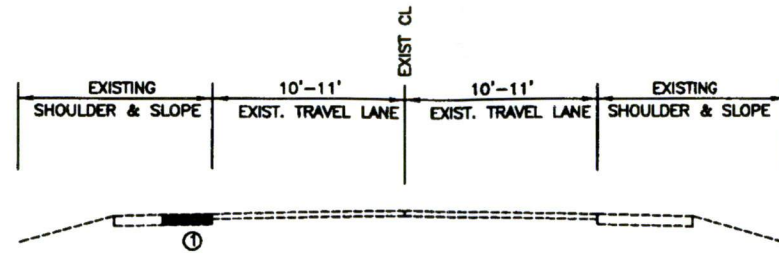
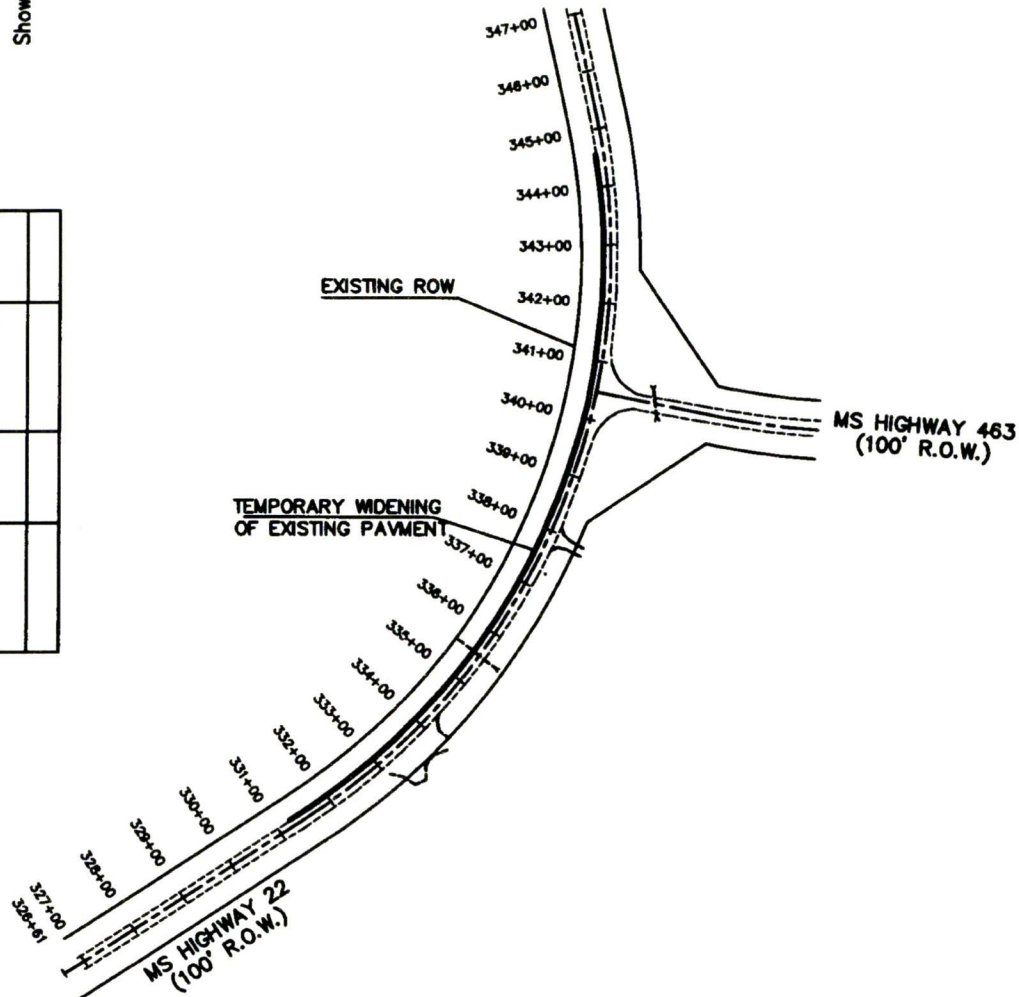

MS HIGHWAY 22 SECTION B.O.P TO E.O.P.

① TEMPORARY 3' WIDE X 3" BASE COURSE ASPHALT

PROPOSED TEMPORARY ROADWAY WIDENING

NOTES:

- TEMPORARY WIDENING TO BE CONSTRUCTED FOR THE NORTH SIDE OF THE WEST BOUND LANE FOR THE ENTIRE LENGTH OF PROJECT WIDENING IN ORDER TO INSTALL THE NECESSARY TRAFFIC CONTROL AND RE-STRIPPING.
- UPON COMPLETION OF THE EAST BOUND LANE WIDENING THE TEMPORARY ASPHALT PAVEMENT SHALL TO BE REMOVED AND THE PERMANENT WIDENING TO BE CONSTRUCTED.

LEGEND

- PROPOSED TEMPOARY ASPHALT WIDENING
- EXISTING EDGE OF PAVEMENT
- CENTERLINE OF ROADWAY

Supplement to:
MND-001
MND-002
MND-004



ShowNorth

MISSISSIPPI DEPARTMENT OF TRANSPORTATION

REVISIONS		MDOT	
APPLICANT	DATE	DATE	BY
	06/20/14		JBH
	07/21/14		JBH

Sheet No.: 6 of 14

Permit No.: 17114

Scale 1"=300'

SLOPES MAY VARY DUE TO SUPER ELEVATION

*TAPER LANE STATION: 333+05.27 TO 334+55.27

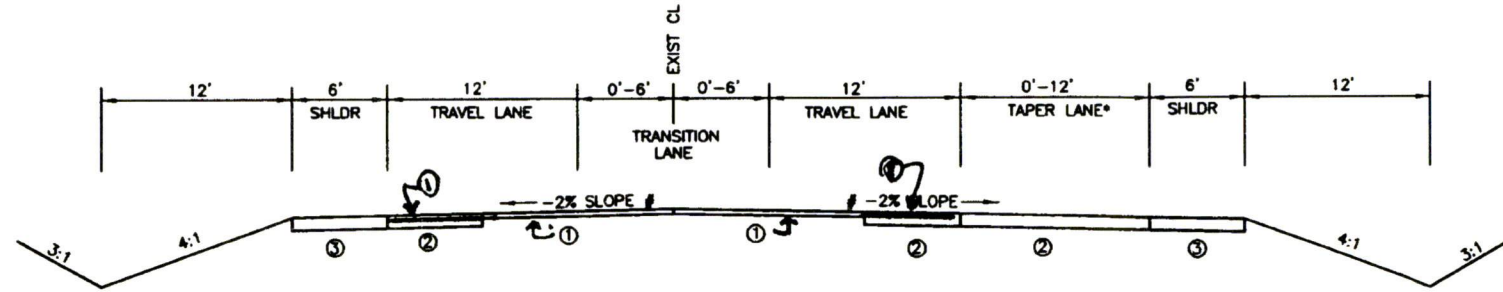

MS HIGHWAY 22 SECTION B.O.P. TO 334+55.27

- ① 24' WIDE EXISTING ASPHALT
OVERLAY WITH 1.5" ~~SURFACE COURSE ASPHALT~~ HMA MT 9.5 mm Mix
- ② 0-18' OF ROADWAY WIDENDING
6" CRUSHED LIMESTONE BASE
8" ~~BASE COURSE ASPHALT~~
1.5" ~~SURFACE COURSE ASPHALT~~
 - 1 @ 2" HMA 12.5 mm Mix
 - 2 @ 3" HMA 19 mm Mix
- ③ 6' GRAVEL SHOULDER
15.5" GRANULAR MATERIAL (CLASS 5, GROUP E)

Sheet No.: 7 of 14
Permit No.: 1711/14
Scale 1"=300'



Show North

REVISIONS		MIDOT	
APPLICANT	DATE	DATE	BY
	06/20/14		JBH
	07/21/14		JBH

SLOPES MAY VARY DUE TO SUPER ELEVATION

*TAPER LANE STATION: 335+61.31 TO 337+11.31

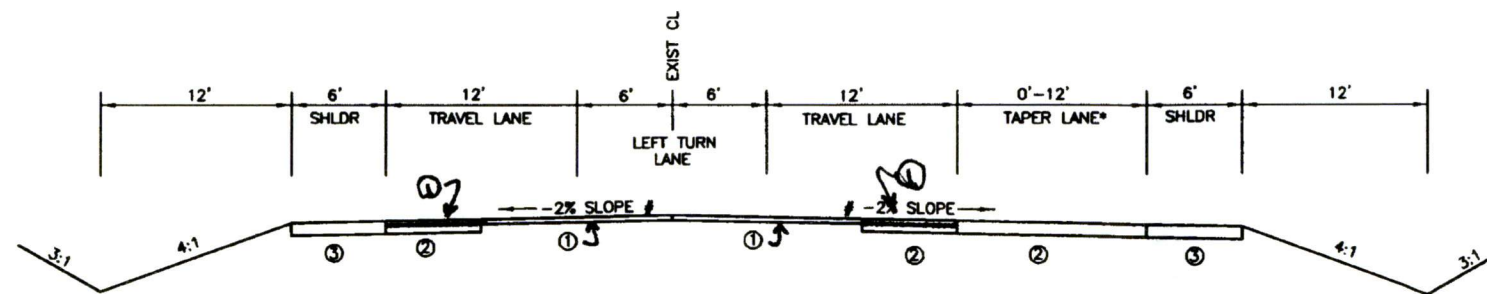

MS HIGHWAY 22 SECTION 334+55.27 TO 341+25.41

- ① 24' WIDE EXISTING ASPHALT
OVERLAY WITH 1.5" ~~SURFACE COURSE ASPHALT~~ HMA MT 9.5 mm Mix
- ② 0-18' OF ROADWAY WIDENING
6" CRUSHED LIMESTONE BASE
8" ~~BASE COURSE ASPHALT~~ → { 1 @ 2" HMA MT 12.5 mm Mix
2 @ 3" HMA MT 19 mm Mix
1.5" ~~SURFACE COURSE ASPHALT~~
- ③ 6' GRAVEL SHOULDER
15.5" GRANULAR MATERIAL (CLASS 5, GROUP E)

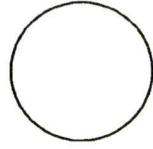

ShowNorth

REVISIONS		MDOT	
APPLICANT	DATE	DATE	BY
	06/20/14		JBH
	07/21/14		JBH

Sheet No.: 8 of 14

Permit No.: 7114

Scale 1"=300'

SLOPES MAY VARY DUE TO SUPER ELEVATION

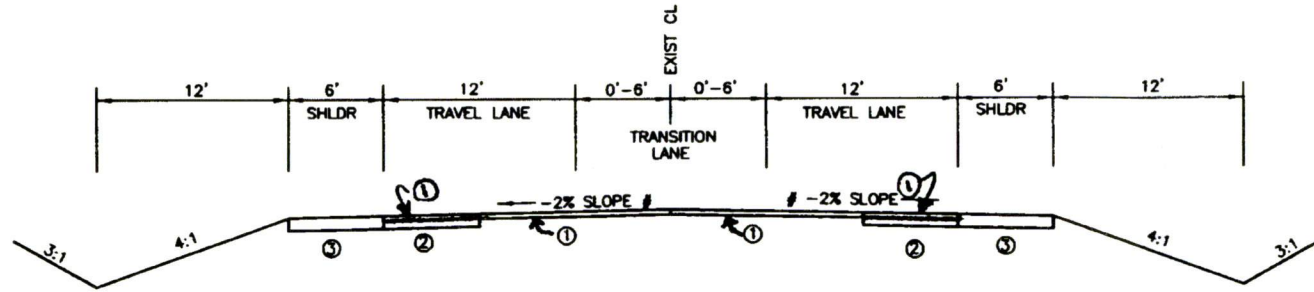

MS HIGHWAY 22 SECTION 341+25.41 TO E.O.P.

- ① 24' WIDE EXISTING ASPHALT
OVERLAY WITH 1.5" ~~SURFACE COURSE ASPHALT~~ HMA MT 9.5mm Mix
- ② 0-6' OF ROADWAY WIDENDING
6" CRUSHED LIMESTONE BASE
8" ~~BASE COURSE ASPHALT~~ → { 1 @ 2" HMA MT 12.5 Mix
2 @ 3" HMA MT 19mm Mix
1.5" ~~SURFACE COURSE ASPHALT~~
- ③ 6' GRAVEL SHOULDER
15.5" GRANULAR MATERIAL (CLASS 5, GROUP E)

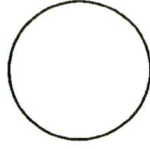

ShowNorth

REVISIONS		MIDOT	
APPLICANT	BY	DATE	BY
	JBH	06/20/14	
	JBH	07/21/14	

Sheet No.: 9 of 14
 Permit No.: 17114
 Scale 1"=300'

SLOPES MAY VARY DUE TO SUPER ELEVATION

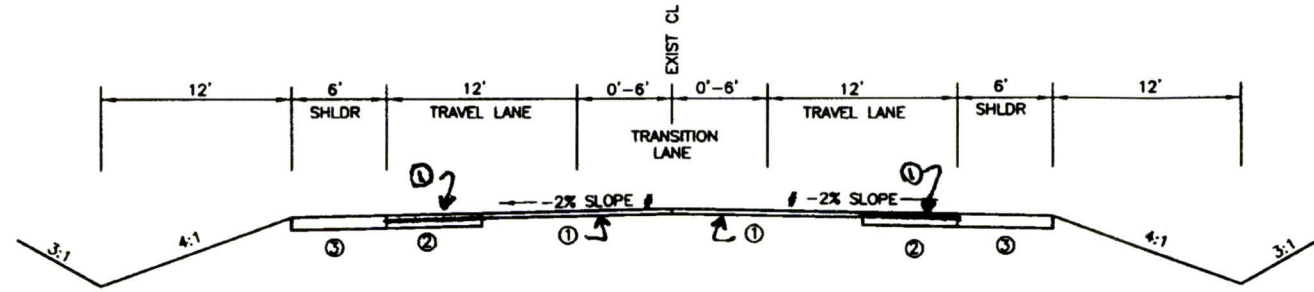

MS HIGHWAY 463 SECTION 467+71.37 TO 470.71.37

- ① 24' WIDE EXISTING ASPHALT
 OVERLAY WITH 1.5" ~~SURFACE COURSE ASPHALT~~ HMA MT 9.5mm Mix
- ② 0-6' OF ROADWAY WIDENDING
 6" CRUSHED LIMESTONE BASE
 8" ~~BASE COURSE ASPHALT~~
 1.5" ~~SURFACE COURSE ASPHALT~~
 - { 1 @ 2" HMA MT 12.5mm Mix
 - 2 @ 3" HMA MT 19mm Mix
- ③ 6' GRAVEL SHOULDER
 15.5" GRANULAR MATERIAL (CLASS 5, GROUP E)

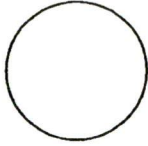

ShowNorth

REVISIONS		MDOT	
APPLICANT	DATE	BY	DATE
	06/20/14	JBH	
	07/21/14	JBH	

Sheet No.: 10 of 14

Permit No.: 17114

Scale 1"=300'

SLOPES MAY VARY DUE TO SUPER ELEVATION

TURNING RADIUS NOTE:

CURB TO BE REPLACED ON BOTH RADIUS' AT THE INTERSECTION OF HIGHWAY 463 AND HIGHWAY 22 WITH TYPE 2 CURB.

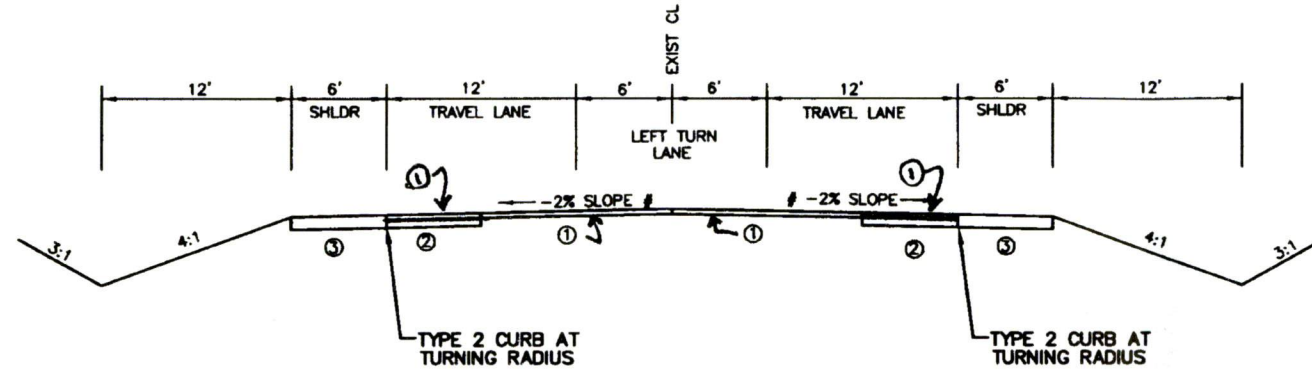

MS HIGHWAY 463 SECTION 470+71.37 TO 471+71.37

- ① 24' WIDE EXISTING ASPHALT
OVERLAY WITH 1.5" SURFACE COURSE ASPHALT HMA MT 9.5mm Mix
- ② 0-6' OF ROADWAY WIDENDING
6" CRUSHED LESTONE BASE
8" BASE COURSE ASPHALT
4.5" SURFACE COURSE ASPHALT
 - 1 @ 2" HMA MT 12.5mm Mix
 - 2 @ 3" HMA MT 19mm Mix
- ③ 6' GRAVEL SHOULDER
15.5" GRANULAR MATERIAL (CLASS 5, GROUP E)

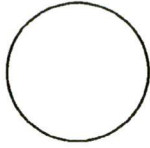

Show North

REVISIONS		APPLICANT	MDOT
DATE	BY	DATE	BY
06/20/14	JBH		
07/21/14	JBH		

Sheet No.: 11 of 14

Permit No.: 17114

Scale 1"=300'

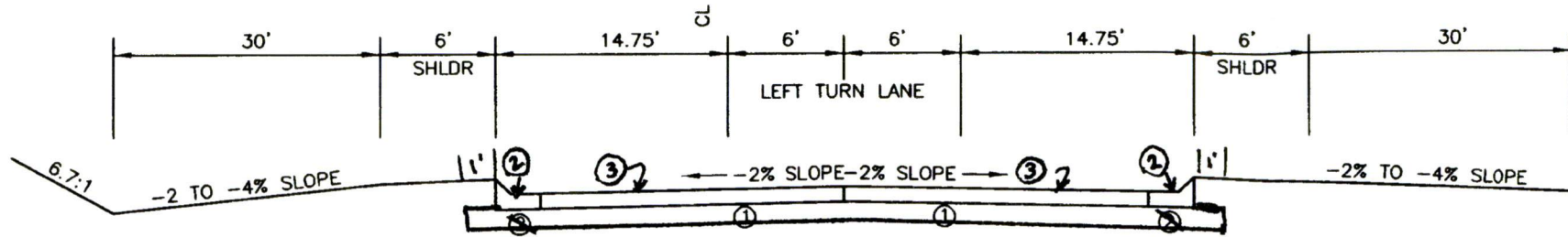

PROPOSED DRIVEWAY #1 (ON HIGHWAY ROW)

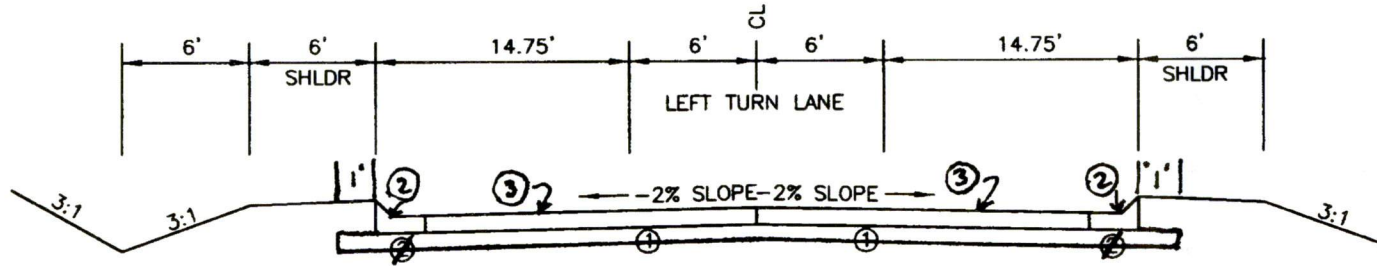

PROPOSED DRIVEWAY #1 (OFF HIGHWAY ROW)

- ① 12" LIME TREATED SUBGRADE (6%)
~~3" ASPHALT BASE COURSE~~
~~3" ASPHALT SURFACE COURSE~~
- ② MDOT TYPE "2" CURB AND GUTTER
- ③ 1 1/2" HMA MT 9.5 mm Mix
2" HMA MT 12.5 mm Mix
2 1/2" HMA MT 19 mm Mix

Supplement to:
MND-001
MND-002
MND-004



ShowNorth

MISSISSIPPI DEPARTMENT OF TRANSPORTATION

MND-005
Rev. 2-93

REVISIONS		APPLICANT	BY	DATE	MDOT	BY
			JBH	06/20/14		
			JBH	07/16/14		
			JBH	07/21/14		
			JBH	07/24/14		

Sheet No.: 12 of 14
Permit No.: 17114
Scale 1"=30'

PROPOSED DRIVEWAY #1

* PROPOSED INLET TOPS SHALL BE FIELD VERIFIED PRIOR TO INSTALLATION

DRAINAGE PIPE FLOW FOR EXISTING 18" RCP:

DRAINAGE AREA: 1.8 ACRES
Q₁₀₀ 13.72 CFS
PIPE CAPACITY: 18.37 CFS

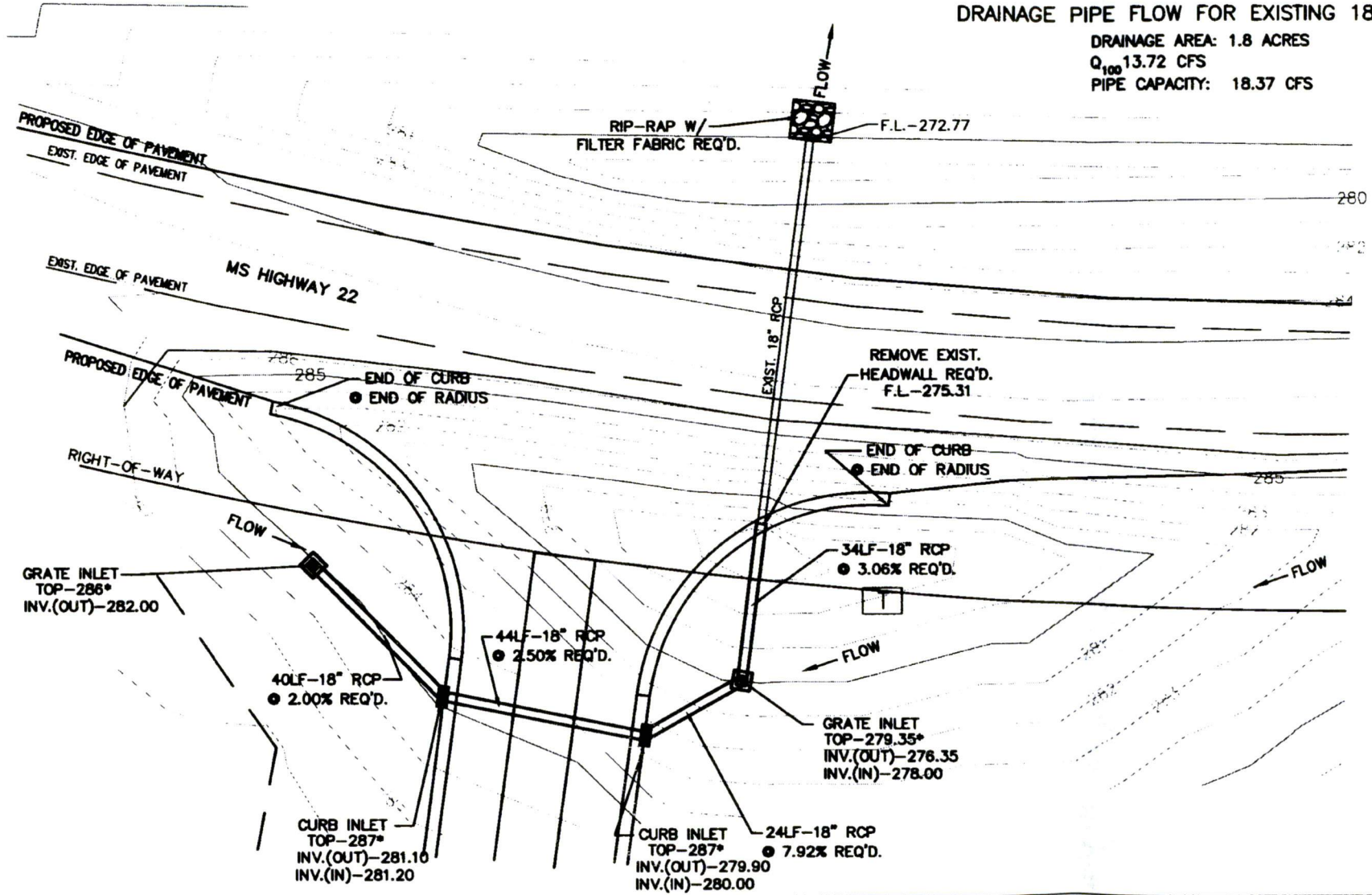

MND-005
Rev. 2-83

MISSISSIPPI DEPARTMENT OF TRANSPORTATION

Supplement to:
MND-001
MND-002
MND-004

Sheet No.: 13 of 14

Permit No.: 17114

Scale 1"=20'

REVISIONS			
APPLICANT	DATE	BY	MDOT
	07/21/14	JBH	



ShowNorth

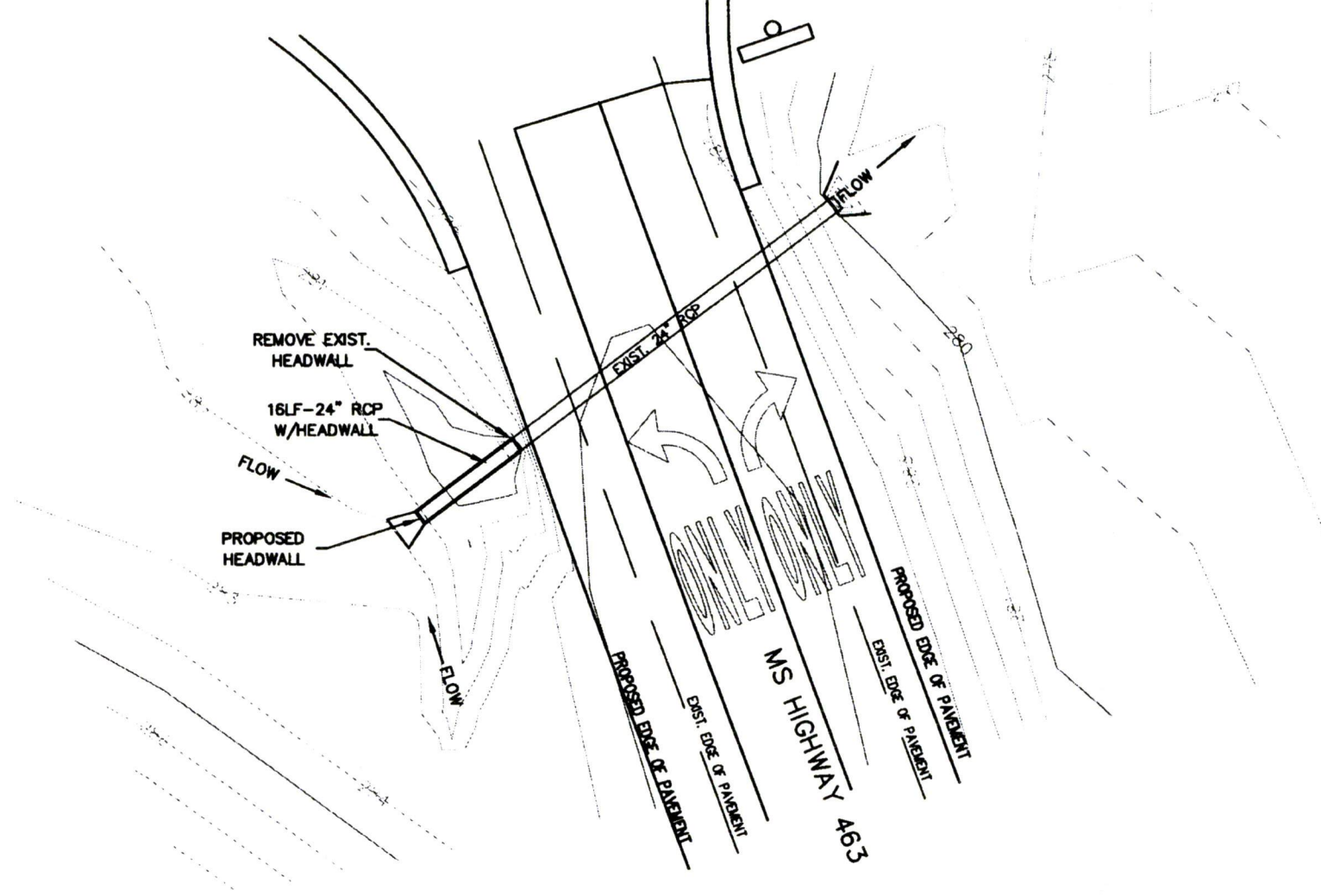

PROPOSED PIPE EXTENSION #1

Supplement to:
MND-001
MND-002
MND-004

MISSISSIPPI DEPARTMENT OF TRANSPORTATION

MND-005
Rev. 2-93



ShowNorth

REVISIONS		APPLICANT	MDOT
DATE	BY	DATE	BY
09/16/14	JBH	9-17-14	MH

Sheet No.: _____ of _____
Permit No.: 17114
Scale 1"=300'

PROPOSED PIPE REPLACEMENT

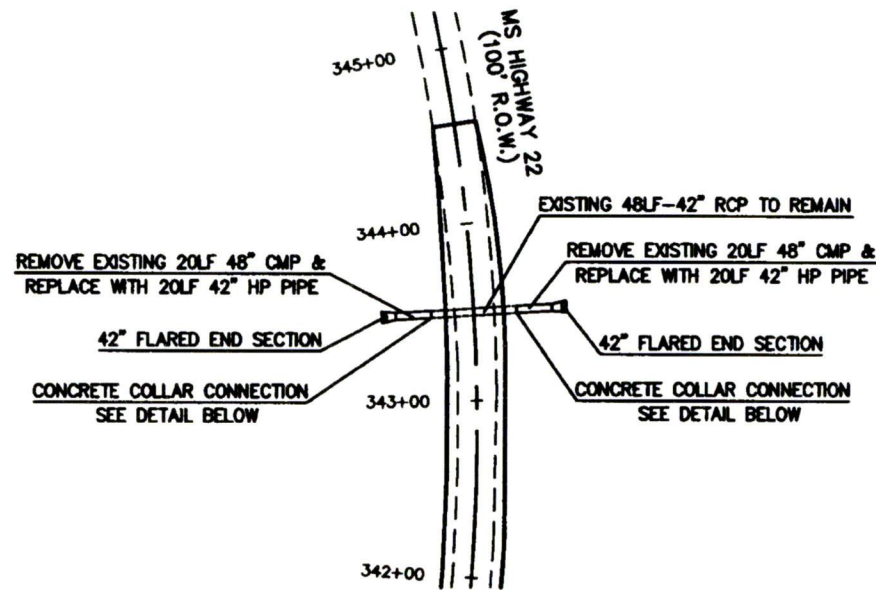

CONCRETE COLLAR CONNECTION DETAIL

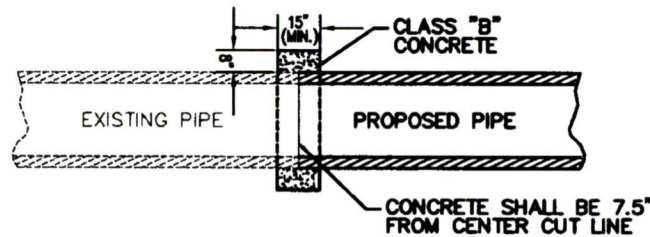

ADS HP STORM 12"- 60" PIPE SPECIFICATION

Scope

This specification describes 12- through 60-inch (300 to 1500 mm) ADS HP Storm pipe for use in gravity-flow storm drainage applications.

Pipe Requirements

- 12- through 30-inch (300 to 750 mm) pipe shall have a smooth interior and annular exterior corrugations and meet or exceed ASTM F2736 and AASHTO MP-21-11
- 36- through 60-inch (900 to 1500 mm) pipe shall have a smooth interior and annular exterior corrugations and meet or exceed ASTM F2881 and AASHTO MP-21-11
- Manning's "n" value for use in design shall be 0.012

Joint Performance

Pipe shall be joined with a gasketed integral bell & spigot joint meeting the requirements of ASTM F2736 and F2881, for the respective diameters.

12- through 60-inch (300 to 1500 mm) shall be watertight according to the requirements of ASTM D3212.

Spigots shall have gaskets meeting the requirements of ASTM F477. Gasket shall be installed by the pipe manufacturer and covered with a removable, protective wrap to ensure the gasket is free from debris. A joint lubricant available from the manufacturer shall be used on the gasket and bell during assembly.

12- through 60-inch (300 to 1500 mm) diameters shall have a reinforced bell with a polymer composite band installed by the manufacturer.

Fittings

Fittings shall conform to ASTM F2736, ASTM F2881 and AASHTO MP-21-11, for the respective diameters. Bell & spigot connections shall utilize a spun-on, welded or integral bell and spigot with gaskets meeting ASTM F477. Bell & spigot fittings joint shall meet the watertight joint performance requirements of ASTM D3212. Corrugated couplings shall be split collar, engaging at least 2 full corrugations.

Field Pipe and Joint Performance

To assure watertightness, field performance verification may be accomplished by testing in accordance with ASTM F2487. Appropriate safety precautions must be used when field-testing any pipe material. Contact the manufacturer for recommended leakage rates.

Material Properties

Polypropylene compound for pipe and fitting production shall be impact modified copolymer meeting the material requirements of ASTM F2736, Section 4, ASTM F2881, Section 5 and AASHTO MP-21-11, Section 6.1, for the respective diameters.

Installation

Installation shall be in accordance with ASTM D2321 and ADS recommended installation guidelines, with the exception that minimum cover in traffic areas for 12- through 48-inch (300 to 1200 mm) diameters shall be one foot. (0.3 m) and for 60-inch (1500 mm) diameters, the minimum cover shall be 2 ft. (0.6 m) in single run applications. Backfill for minimum cover situations shall consist of Class 1, Class 2 (minimum 90% SPD) or Class 3 (minimum 95%) material. Maximum fill heights depend on embedment material and compaction level; please refer to Technical Note 2.04. Contact your local ADS representative or visit our website at www.ads-pipe.com for a copy of the latest installation guidelines.

Pipe Dimensions

Nominal Pipe I.D. in (mm)	12 (300)	15 (375)	18 (450)	24 (600)	30 (750)	36 (900)	42 (1050)	48 (1200)	60 (1500)
Average Pipe I.D. in (mm)	12.1 (307)	14.9 (378)	18.0 (457)	24.1 (612)	30.1 (765)	35.7 (907)	41.8 (1062)	47.3 (1201)	59.3 (1506)
Average Pipe O.D. in (mm)	14.5 (368)	17.8 (447)	21.2 (538)	28.0 (711)	35.4 (899)	41.1 (1044)	47.2 (1199)	53.8 (1367)	66.5 (1689)
Minimum Pipe Stiffness* @ 5% Deflection* #in./in. (kN/m ²)	75 (520)	80 (411)	56 (385)	50 (343)	45 (320)	40 (275)	35 (240)	35 (240)	30 (205)

* Minimum pipe stiffness values listed; contact a representative for maximum values

Supplement to:
MND-001
MND-002
MND-004

MISSISSIPPI DEPARTMENT OF TRANSPORTATION

MND-005
Rev. 2-93



ShowNorth

EROSION CONTROL PLAN

REVISIONS		APPLICANT	MDOT
DATE	BY	DATE	BY
07/21/14	JBH		

Sheet No.: 14 of 14

Permit No.: 17114

Scale 1"=300'

SYMBOLS FOR EROSION AND SEDIMENT CONTROL PRACTICES

TEMPORARY PRACTICES

- - - - SILT FENCE (TYPE "A")
-  STORM DRAIN INLET PROTECTION (SILT FENCE, STRAW WATTLE)
-  STRAW WATTLE CHECK DAM

VEGETATIVE PRACTICES

-  PERMANENT SEEDING

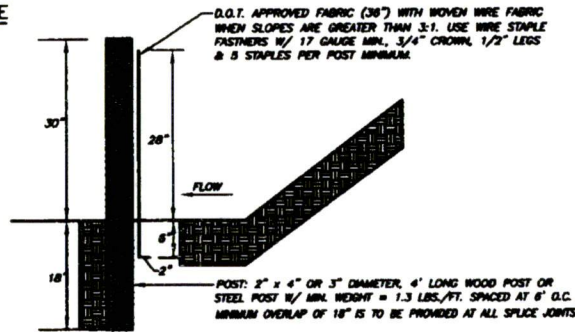
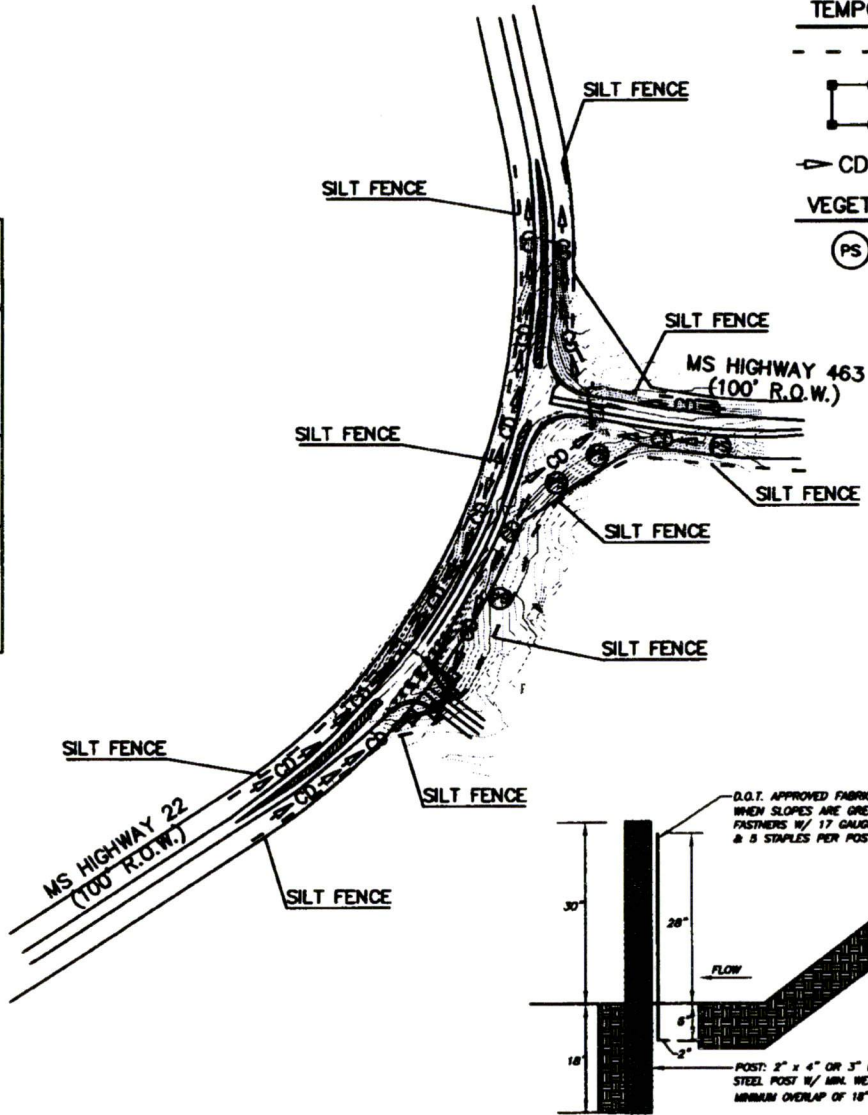

PLANNED EROSION, SEDIMENT AND STORMWATER CONTROL PRACTICES

1. STORM DRAIN INLET PROTECTION. TEMPORARY HAY BALE AND SILT FENCE COMBINATIONS WILL BE INSTALLED AT ALL CURB INLET AND GRATE INLET LOCATIONS.
2. LAND GRADING. EXCESS EXCAVATION FROM THE SITE WILL BE PLACED ON THE SITES LOWEST ELEVATION. ALL FILL MATERIALS WILL BE COMPACTED AND SLOPES WILL NOT EXCEED 3:1. ALL AREAS WILL RECEIVE SEEDING FOR STABILIZATION OF THE FILL MATERIAL UNTIL PERMANENT VEGETATION IS ESTABLISHED AFTER COMPLETED CONSTRUCTION.

3. CULVERT PROTECTION. STRAW WATTLES WILL BE LOCATED AT THE INLETS AND OUTLET OF ALL CULVERTS TO PREVENT SCOUR.
3. CULVERT PROTECTION. STRAW WATTLES WILL BE LOCATED AT THE INLETS AND OUTLET OF ALL CULVERTS TO PREVENT SCOUR.
4. PERMANENT SEEDING. ALL DISTURBED AREAS WILL BE PERMANENTLY SEEDING AND MULCHED ONCE FINAL GRADE IS ESTABLISHED. THE LAND GRADING AREAS PREVIOUSLY MENTIONED WILL RECEIVE TEMPORARY SEEDING AS STATED.

MAINTENANCE PLAN

SHORT TERM

1. ALL EROSION AND SEDIMENT CONTROL PRACTICES WILL BE CHECKED FOR STABILITY AND OPERATION FOLLOWING EVERY RUNOFF-PRODUCING RAINFALL BUT IN NO CASE LESS THAN EVERY WEEK. ANY NEEDED REPAIRS WILL BE MADE IMMEDIATELY TO MAINTAIN ALL PRACTICES AS DESIGNED.
2. SEDIMENT WILL BE REMOVED FROM THE INLET PROTECTION DEVICES WHEN IT REACHES A MAXIMUM OF 6 INCHES DEEP. THE DEVICE WILL BE REPLACED AS NECESSARY TO MAINTAIN A BARRIER.
3. ALL SEEDED AREAS WILL BE FERTILIZED AND RESEED AS NECESSARY TO MAINTAIN A DENSE VEGETATIVE COVER.

LONG TERM

1. ALL VEGETATED AREAS WILL BE MAINTAINED IN ADEQUATE CONDITION TO PROVIDE PROPER GROUND COVER.
2. AREAS WHERE VEGETATION IS LOST WILL BE FERTILIZED, SEEDING AND MAINTAINED AS NECESSARY TO RESTORE PROPER GROUND COVER.
3. STRUCTURAL MEASURES WILL BE EXAMINED AT LEAST ANNUALLY AND MAINTENANCE PERFORMED AS NEEDED.

GENERAL NOTES

1. DURING CONSTRUCTION THE CONTRACTOR IS RESPONSIBLE FOR IMPLEMENTING AND MAINTAINING THE NECESSARY EROSION CONTROL MEASURES AS GRADE CHANGES ARE MADE.



*State of Mississippi
Department of Environmental Quality
Office of Pollution Control*

Certificate of Permit Coverage

under Mississippi's Large Construction Storm Water General NPDES Permit

Be it known

**Town of Livingston, The
Ridgeland, Mississippi**

having submitted an acceptable Construction Notice of Intent, is hereby granted this Certificate of Permit Coverage in order to discharge storm water associated with the construction of

**Town of Livingston, The
Receiving Stream: Persimmon Creek
Madison County**

A handwritten signature in black ink, appearing to read "Sam Lewis".

Chief, General Permits Branch

*Coverage No: MSR106021
Date of Coverage: September 21, 2011
Date General Permit Expires: December 31, 2015*

56233 GNP20110001

14Aof14

The measures and land treatments shown on this plan are applicable to activities during site development and utility construction which disturb ground surfaces and/or contribute to the pollution of stormwater from eroded soil sediments and debris. All controls must be in accordance with the standards set forth in the 1994 edition of PLANNING AND DESIGN MANUAL FOR THE CONTROL OF EROSION, SEDIMENT AND STORMWATER published by the Mississippi Department of Environmental Quality and U.S. Department of Agriculture Natural Resources Conservation Agency. In addition, all controls must be in accordance with any general or special conditions of the Certificate of Permit Coverage under the State of Mississippi's Storm Water Construction General National Pollutant Discharge Elimination System Permit issued by the Mississippi Department of Environmental Quality for this project.

Madison County Standards shall be followed when constructing the storm sewer system.

Each contractor performing any work required or implied on the Construction Plans of which the SWPPP is a part, during the period from the date the contractor mobilizes on the project site until the date his work is completely finished, shall weekly monitor, inspect, repair or replace within 24 hours of discovery, maintain and supplement as required such and all of the erosion control facilities required by this SWPPP. Each contractor shall erect, operate, maintain, monitor and monitor a rain gauge. Following any storm event in which the gauge indicates that more than three (3) inches of rain fell in a 24 hour period, or after any storm event which the County or Engineer indicated the necessity of so doing, as soon as field conditions allow, the contractor shall monitor, inspect, repair, replace, maintain and supplement as required any erosion controls which have failed to function as intended.

Contractors who fails or omits to employ and implement appropriate and practicable erosion and sediment control measures and practices or who intentionally or unintentionally destroys or damages any erosion or sediment control facility shall be responsible for damages to downstream properties caused by erosion of soil sediments stemming from such failure, omission, or destruction and shall promptly clean or repair ditches, drainage culverts or inlets clogged or otherwise affected by such erosion.

The Developer, Contractors, and/or Subcontractors shall provide labor and equipment for the removal of mud, sediment and debris from the streets affected by their actions during this project.

At the completion of the project the contractor will flush out the entire storm drain system, under the phase to eliminate any sediment or debris that may have collected during construction.

HAY BALES AND ADDITIONAL SILT FENCE TO BE UTILIZED AS NECESSARY TO PREVENT SILTATION FROM ESCAPING SITE. HAY BALES TO BE USED AROUND INLETS AS SHOWN ON SHEET 2.

SEE SHEET 2 FOR INSTALLATION DETAILS FOR EROSION CHECKS AND SILT FENCE.

DEVELOPER TO TAKE ANY MEASURES NECESSARY, WHICH MAY BE GREATER THAN THOSE SHOWN HEREON, TO PREVENT SILTATION FROM ESCAPING SITE.

— DENOTES SILT FENCE

TRASH RECEPTACLE AND PORTABLE TOILET TO BE PROVIDED DURING CONSTRUCTION.

NO STORAGE OF PAINTS, SOLVENTS, CHEMICALS ETC ALLOWED ON SITE.

DEVELOPER WILL BE RESPONSIBLE FOR THE IMPLEMENTATION AND MAINTENANCE OF THE EROSION CONTROL MEASURES REQUIRED BY MADISON COUNTY AND APPROVED IN THE MISSISSIPPI DEPARTMENT OF ENVIRONMENTAL QUALITY STORMWATER POLLUTION PREVENTION PLAN (SWPPP).

IF ANY DISTURBED AREA WILL BE LEFT UNDISTURBED FOR MORE THAN 14 DAYS, A TEMPORARY OR PERMANENT VEGETATIVE PRACTICE WILL BE IMPLEMENTED WITHIN 7 DAYS.

EROSION CONTROL MEASURES SHALL BE INSPECTED PER THE MOED SWPPP REQUIREMENTS.

DEVELOPER WILL BE RESPONSIBLE FOR THE IMPLEMENTATION AND MAINTENANCE OF THE EROSION CONTROL MEASURES REQUIRED BY MADISON COUNTY AND APPROVED IN THE MISSISSIPPI DEPARTMENT OF ENVIRONMENTAL QUALITY STORMWATER POLLUTION PREVENTION PLAN (SWPPP).

ALL BRICK MANHOLES SHALL BE INSPECTED BY THE COUNTY PRIOR TO BACKFILLING SAID BRICK MANHOLES.

ALL DEVELOPERS, ENGINEERS, CONTRACTORS AND SUBCONTRACTORS SHALL MAKE THEMSELVES FAMILIAR WITH STATE LAWS AND MADISON COUNTY'S ORDINANCES BEFORE CONSTRUCTION BEGINS.

- COUNTY:
- SUBDIVISION DEVELOPMENT REGULATION
 - ZONING ORDINANCE
 - LANDSCAPE ORDINANCE

- STATE OF MISSISSIPPI:
- PLANNING AND DESIGN MANUAL FOR THE CONTROL OF EROSION, SEDIMENT AND STORMWATER (MOED 1994)
 - FIELD MANUAL - FOR EROSION AND SEDIMENT CONTROL ON CONSTRUCTION SITES IN MISSISSIPPI
 - STORMWATER CONSTRUCTION GENERAL NATIONAL POLLUTANT DISCHARGE ELIMINATION SYSTEM PERMIT

CONTRACTOR SHALL BE RESPONSIBLE FOR ENSURING THAT HWY 463 AND HWY 22 ARE KEPT FREE OF DEBRIS, MUD, DIRT, OR OTHER SUBSTANCES THAT ARE A RESULT OF THIS CONSTRUCTION.

SIDEWALKS SHALL BE CONSTRUCTED TO BE ADA COMPLIANT.

PAD ELEVATIONS ARE THEORETICAL. A SITEPLAN SHOULD BE SUBMITTED FOR EACH BUILDING PRIOR TO RECEIVING A BUILDING PERMIT.

THE COUNTY ENGINEER OR HIS REPRESENTATIVE SHALL BE NOTIFIED 24-HOURS PRIOR TO THE PROOF-ROLLING OF THE SUBGRADE WITH A LOADED TANDEM AXLE TRUCK.

CURB INLET #13
TC=288.34
INV OUT=282.50 (TO CI-14)

CURB INLET #14
TC=288.34
INV IN=279.81 (FROM CI-12)
INV IN=282.30 (FROM CI-13)
INV OUT=279.50 (TO DI-37)

CURB INLET #23
TC=289.50
INV IN=285.55 (FROM CI-22)
INV OUT=285.45 (TO CI-24)

CURB INLET #24
TC=289.50
INV IN=285.32 (FROM CI-23)
INV OUT=281.70 (TO DI-36)

DROP INLET #35
TDP=281.75
INV IN=278.00 (FROM CI-32)
INV IN=274.13 (FROM CI-34)
INV OUT=273.63 (TO DI-36)

DROP INLET #36
TOP=283.00
INV IN=278.00 (FROM CI-24)
INV IN=272.90 (FROM DI-35)
INV OUT=272.40 (TO DI-37)

DROP INLET #37
TDP=283.90
INV IN=278.72 (FROM CI-14)
INV IN=271.42 (FROM DI-36)
INV OUT=271.00

CI-13 TO CI-14
20'-15" RCP @ 1.00%

CI-14 TO DI-37
78'-24" RCP @ 1.00%

CI-23 TO CI-24
22'-18" RCP @ 0.60%

CI-24 TO DI-36
74'-18" RCP @ 5.00%

DI-35 TO DI-36
182'-24" HDPE @ 0.40%

DI-36 TO DI-37
244'-30" HDPE @ 0.40%

DI-37 TO FE
160'-36" HDPE @ 0.40%

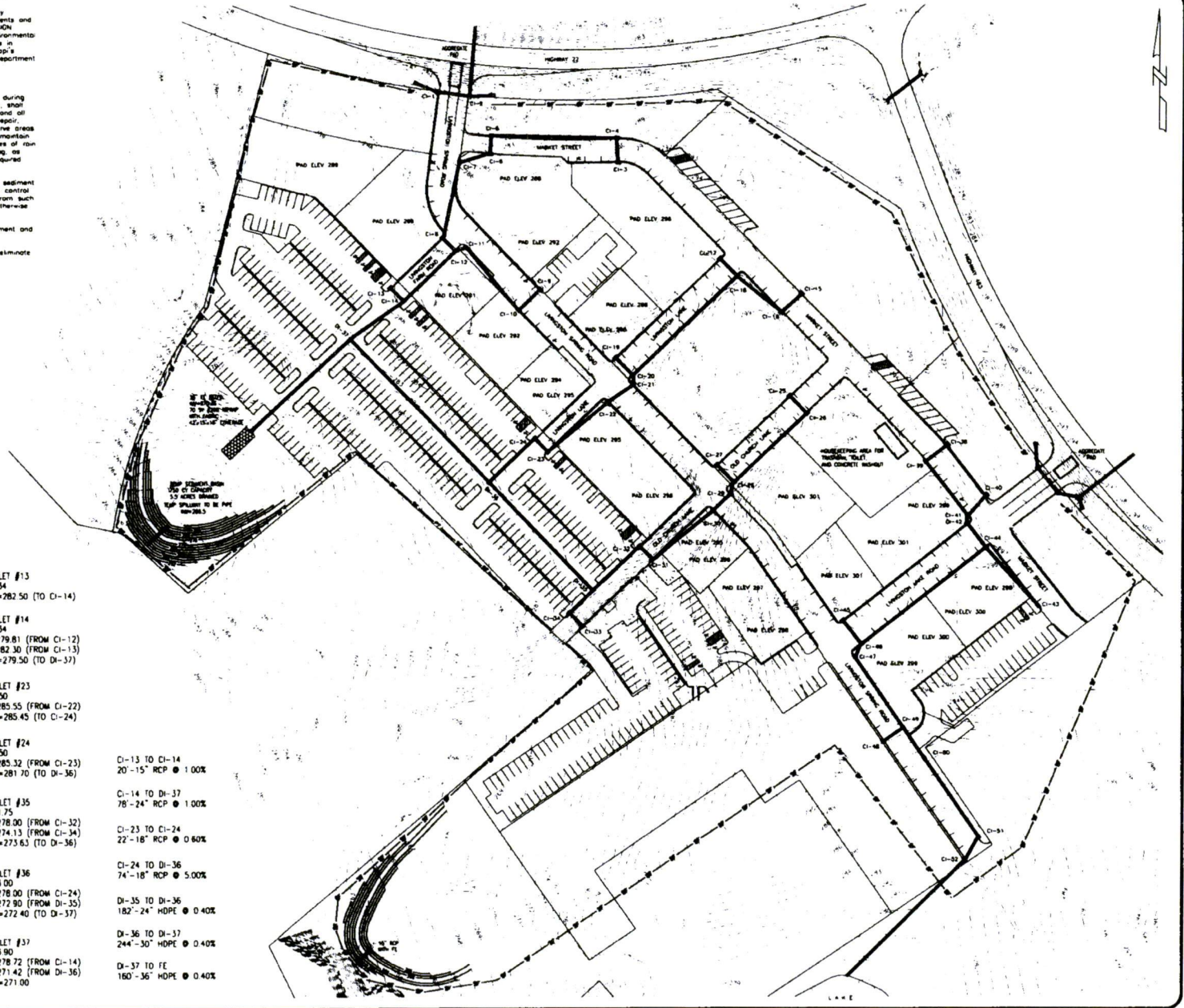

1/8 of 14

DATE	REVISION

DRAWING NAME: S:\PROJECTS\02-09\SWPPP\SWPPP.DWG
DRAWN BY: NPM SCALE: 1" = 80'
DATE OF DRAWING: 8-11 PROJECT NO: 802-09
CHECKED BY: _____ APPROVED BY: _____

B BANKS ENGINEERING & SURVEYING, INC.
115 LONE WOLF DRIVE SUITE B • MADISON, MS 38110
OFFICE (601) 407-1240 • FAX (601) 407-1245

CLIENT:
LIVINGSTON TOWNSHIP, LLC

PROJECT:
**TOWN OF LIVINGSTON
STORMWATER POLLUTION PREVENTION PLAN
MADISON COUNTY, MISSISSIPPI**

SHEET NO.
1 OF 2

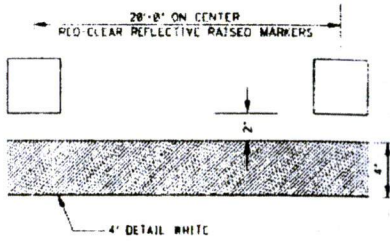

DETAIL C

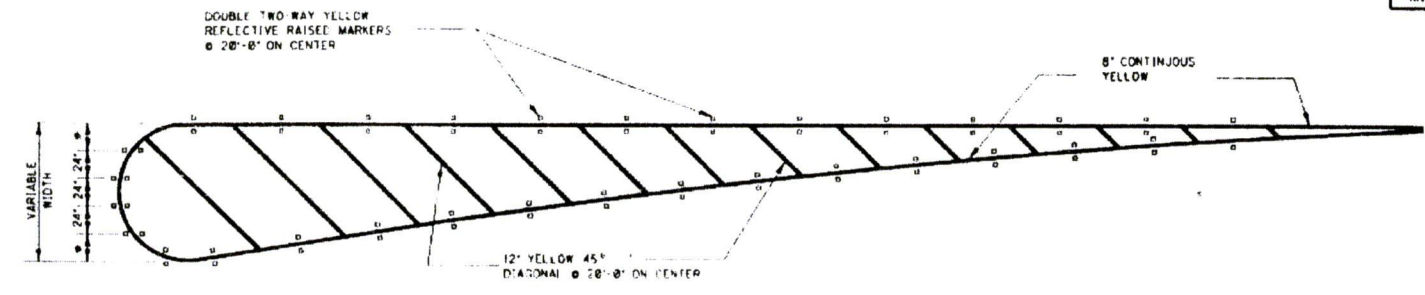

DETAIL A

* NOTE: VARIABLE 124" MAXIMUM

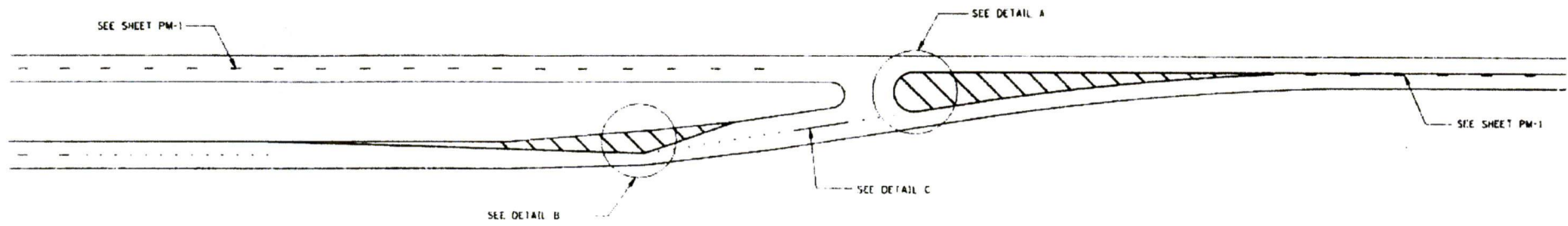

PLAN

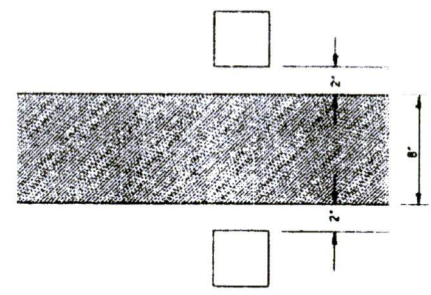

DETAIL D

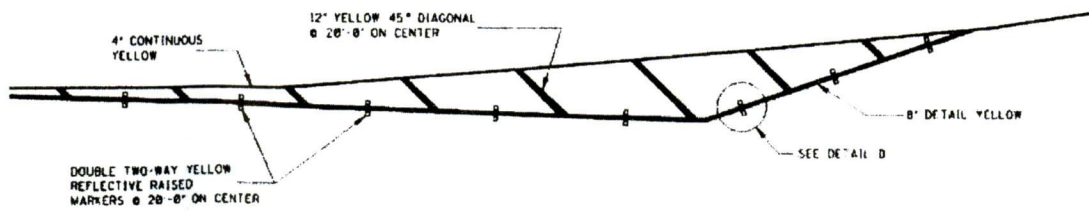

DETAIL B

1420714

MISSISSIPPI DEPARTMENT OF TRANSPORTATION ROADWAY DESIGN DIVISION STANDARD PLAN	
4-LANE TO 2-LANE TRANSITION AT INTERCHANGE	
WORKING NUMBER PM-8	 WORKING NUMBER PM-8 SHEET NUMBER 127
ISSUE DATE: OCTOBER 1, 1998	

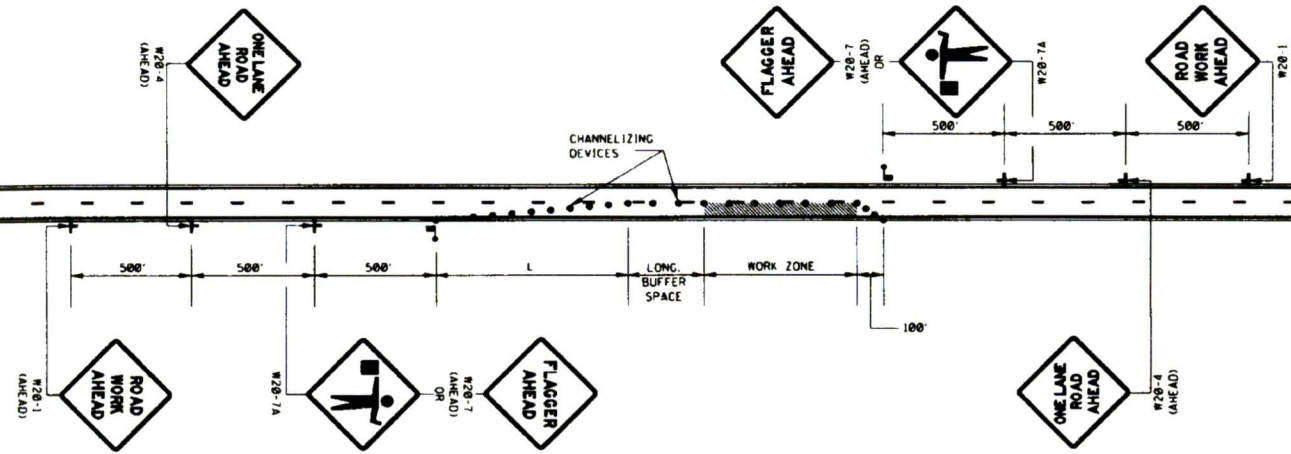

LEGEND
 ■ FLAGGER
 ● CHANNELIZING DEVICES

GENERAL NOTES:

1. THE LOCATION OF CHANNELIZING DEVICES AND THE WORK AREA LAYOUT SHALL BE BASED ON THE CRITERIA IN THE FOLLOWING TABLE:

POSTED SPEED AND/OR DESIGN SPEED	MAXIMUM CHANNELIZING DEVICE SPACING (†)		MINIMUM LONGITUDINAL BUFFER SPACE (†)	TAPER † RATES
	TAPER	ALONG LANE LINE & WORK ZONE		
mph				
≤40	40	80	170	27:1
45	45	90	220	45:1
50	50	100	280	50:1
55	55	110	335	55:1
60	60	120	415	60:1
65	65	130	485	65:1
70	70	140	575	70:1

† NOTE: TAPER RATES ARE DETERMINED USING THE FOLLOWING EQUATIONS:
 $L = WS$ FOR SPEEDS OF 45 MPH OR GREATER
 $L = WS^2/60$ FOR SPEEDS OF 40 MPH OR LESS
 WHERE: L = MINIMUM LENGTH OF TAPER IN FEET
 W = WIDTH OF OFFSET (USUALLY LANE WIDTH) IN FEET
 S = DESIGN SPEED OR 85TH PERCENTILE SPEED IN MILES PER HOUR

- ALL CHANNELIZING DEVICES SHALL BE A MINIMUM OF 24" IN HEIGHT.
- ALL TRAFFIC CONTROL ITEMS SHOWN ON THIS SHEET WILL NOT BE MEASURED FOR SEPARATE PAYMENT. THIS WORK IS TO BE INCLUDED IN THE PRICE BID FOR MAINTENANCE OF TRAFFIC.
- DIAMOND SHAPED TRAFFIC CONTROL SIGNS SHALL BE A MINIMUM OF 48" x 48".
- WHEN THERE IS NO EXISTING HAZARD OR AT THE END OF THE WORK DAY, ALL SIGNS SHALL BE COVERED OR REMOVED AND ALL CHANNELIZING DEVICES SHALL BE MOVED TO THE SHOULDER EDGE.
- WHERE THE WORK ZONE IS STATIONARY, THE W20-7 (500 FT.) SIGN OR THE W20-7A SIGN TOGETHER WITH THE W20-7 (500 FT.) SUPPLEMENTAL PLATE SHOULD BE USED TO INDICATE THE DISTANCE TO THE FLAGGER.

BY		MISSISSIPPI DEPARTMENT OF TRANSPORTATION	
REVISION		ROADWAY DESIGN DIVISION	
		STANDARD PLAN	
TRAFFIC CONTROL PLAN WITH FLAGGER (ONE-LANE CLOSURE OF TWO-WAY TRAFFIC)			
DATE		ISSUE DATE: OCTOBER 1, 1998	WORKING NUMBER TCP-1
			SHEET NUMBER 6250

1400714

Sheet No.: _____ of _____

Permit No.: _____

REVISIONS			
APPLICANT		MDOT	
DATE	BY	DATE	BY

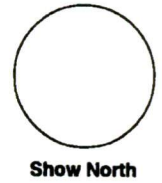

Work on the Shoulder

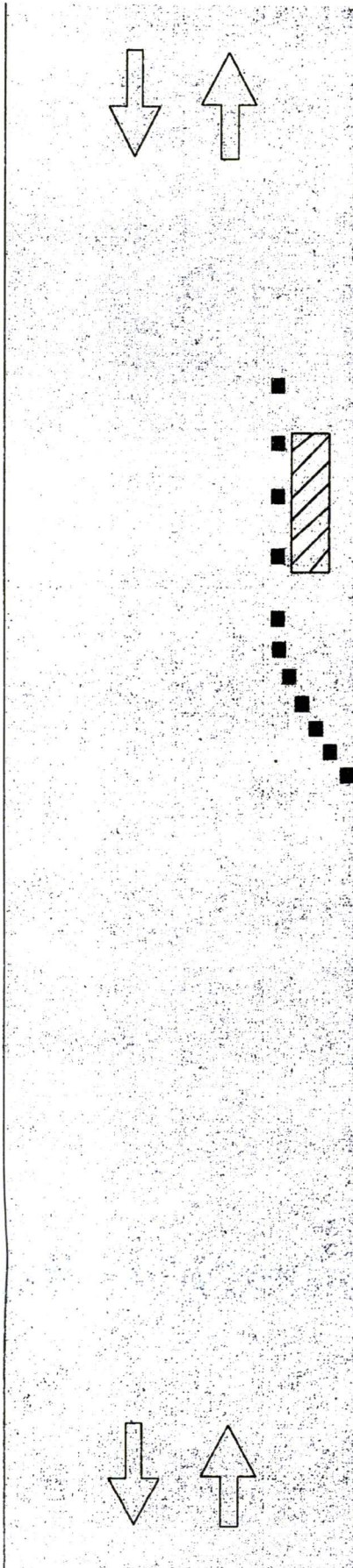

Note: All signs and cones may be eliminated if the duration of work is less than 1 hour and a vehicle with a flashing or rotating yellow light is used.

When paved shoulders having a width of 8 feet or more are closed, at least one advance warning sign shall be used. In addition, channelization devices shall be used to close the shoulder.

Speed (mph)	8' Shoulder Width	10' Shoulder Width	12' Shoulder Width
25	30'	35'	45'
30	40'	50'	60'
35	55'	70'	85'
40	75'	90'	110'
45	120'	150'	180'
50	135'	170'	200'
55	150'	185'	220'
60	180'	200'	240'
65	175'	220'	260'
70	180'	235'	280'

Note: If a road intersects between the advanced warning sign and the work space, place an advanced warning sign on the intersecting roadway.



Road Type	Distance
	A
Urban Low Speed	100'
Urban High Speed	350'
Rural	500'

Sheet No.: _____ of _____

Permit No.: _____

REVISIONS			
APPLICANT		MDOT	
DATE	BY	DATE	BY

**CALL MISSISSIPPI 811
BEFORE WORK STARTS**

Applicant agrees to assume full responsibility for safeguarding and directing traffic in accordance with the Manual Uniform Traffic Control Devices (MUTCD) during this work. All signs and traffic control devices are to be removed from roadway when not in use.

In accordance with the Code of Federal Regulations (CFR) Part 23 – Rule – 634.3--- All workers within the right of way of a Federal-aid highway who are exposed either to traffic (vehicles using the highway for purposes of travel) and/or to construction equipment within the work area shall wear high-visibility safety apparel. High-visibility safety apparel is that which meets the Performance Class 3 of ANSI/ISEA 107-2004 "American National Standard for High-Visibility Safety Apparel and Headwear."

All sod disturbed by the proposed work is to be replaced by applicant and maintained for sufficient length of time to ensure a living and growing sod.

The Mississippi Department of Transportation does not purport to grant permission for, or to become party to any work that will change the flow of existing water on or off State property or to change the disposition of floodwaters.

As a condition for the approval of this permit application, the applicant agrees to perform work as shown on the application, make any necessary repairs of damages to the right- of-way, roadway slopes, shoulders, or pavement, all to the satisfaction of the Department of Transportation Commission and to save the Commission harmless as to all claims arising from work performed under this permit.

It is understood and agreed that any encroachments on adjoining property owners will be secured with easements from said property owners.

The applicant is to give the Permit Department of the MS Department of Transportation notice **forty-eight (48) hours** in advance the time the actual work is begun. Our telephone number is **601-683-3771**.

A copy of the approved plan is to be kept at the site of the work at all times during construction.

The applicant agrees to assume the responsibility for obtaining any and all necessary permits from any other regulating entity prior to beginning any work on state maintained right of way. This can include entities such as but not limited to the municipality, county, MS State Department of Environmental Quality (DEQ) and the United States Corps of Engineers.

The permitted area is subject to inspection by the Mississippi Department of Transportation to ensure compliance with the provisions of the erosion control plan included in this permit.

Inclement weather conditions may require work to be postponed until work can be performed without unnecessary damage to the right- of- way.

The applicant agrees to ensure that any disturbed areas that are not permanently stabilized, and are not scheduled for any activity to take place for 14 days or more, are seeded within seven (7) days of the disturbance.

This permit is issued for stage construction which allows for construction as specified on the application and if the applicant desires to pave or surface this driveway at a later date he can do so, provided that there will be no change in the drainage, grade or width of the driveway.

No part of the Highway right-of-way will be used for any purpose not intended within the meaning of this permit, which is to construct driveway. It is expressly agreed that no part of the right-of-way is to be used for the servicing of vehicles, displays or the conduct of private business. The right-of-way is to be kept clear of buildings, sales exhibits, business signs, parking areas, service equipment and appurtenance thereto.

Vehicles and equipment shall not be parked at **ANYTIME** on the shoulder of the highway. Tracking of mud or debris onto roadway **WILL NOT BE TOLERATED**

SHEET NO. _____ OF _____

PERMIT NO. _____

REVISIONS			
APPLICANT		MDOT	
DATE	BY	DATE	BY

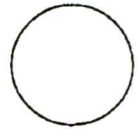

SHOW NORTH

Erosion control implementation schedule:

Phase 1: BMP's are to be installed before any major land disturbing activity. Silt fence is to be installed as depicted in the Erosion Control Plan Sheet and along the perimeter of the downstream side of any disturbed areas.

Phase 2: Soil stabilization - vegetative stabilization measures must be initiated whenever any clearing, grading, excavating, or other land disturbing activities have temporarily or permanently ceased on any portion of the site and will not resume for a period of fourteen (14) days or more. The appropriate temporary or permanent vegetative practices shall be implemented within seven (7) calendar days.
See Temporary Vegetation Schedule

Phase 3: Upon completion of work, any remaining permanent erosion control measures will be installed and any required permanent grassing will be finished.
See Permanent Grassing Schedule

Refer to attached MDOT standard drawings for details on installation

VEGETATION SCHEDULE

1600 All soil preparation, fertilizing, sprigging, seeding and work applied to same shall be in accordance with the following procedure and schedule.

- SHAPE AREA.** Shape all areas to typical cross section and dress same as required by the permit.
- SPREAD FERTILIZER AND PREPARE SEED BED.** The required fertilizer and agricultural limestone shall be spread uniformly over the area to be top seeded. after the fertilizer and limestone has been spread, the area shall be thoroughly pulverized and the fertilizer incorporated in the top four (4) inches of the graded areas.
- KIND AND QUANTITY OF FERTILIZER.** fertilizer and agriculture limestone shall be applied at the following rates:

Combination fertilizer	- 13-13-13	- 800 lbs. per acre
Agricultural limestone	-	2 tons per acre
- SEEDING AND/OR SODDING.** Seeding and/or sodding is required on disturbed areas specified in the permit or by a representative of the Department. All areas should receive the seeding as follows:

Permanent Grassing Schedule		
Common Bermuda	- 15 lbs. per acre	- year round
Bahia	- 30 lbs. per acre	- year round
Fescue (Ky.31)	- 20 lbs. per acre	- August 1 - April 1
Crimson Clover	- 15 lbs. per acre	- August 1 - April 1
Temporary Grassing Schedule		
Rye Grass	- 25 lbs. per acre	- September 1 - March 31
Oats	- 90 lbs. per acre	- September 1 - December 15

No Crimson Clover or Bahia grass is to be planted in the Delta and no Bahia grass is to be planted in city sections

SUPPLEMENT TO:
MND-883
MND-884
MND-885

MISSISSIPPI DEPARTMENT OF TRANSPORTATION

MND-005
REV. 2-93

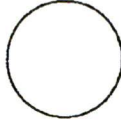

SHOW NORTH

REVISIONS		MOOT
APPLICANT	BY	DATE

SHEET NO. _____ OF _____
PERMIT NO. _____

STATE	PROJECT NO.
MISS.	

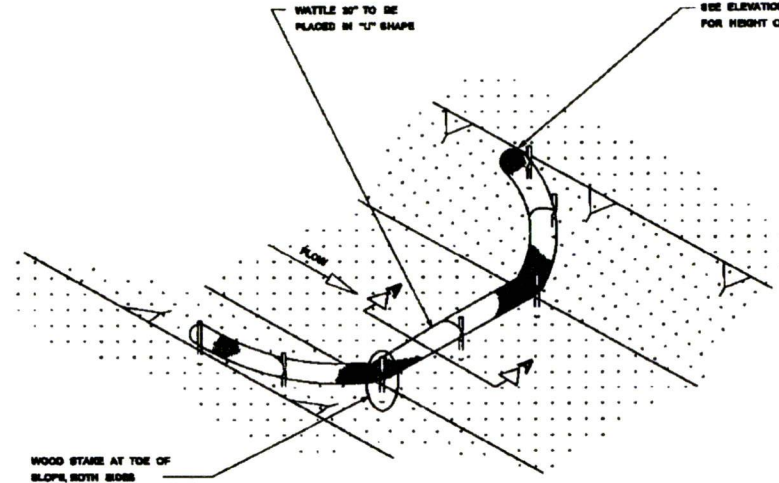

DETAIL (DITCH CHECK)

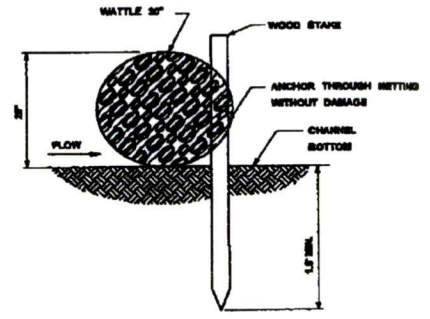

SECTION A-A

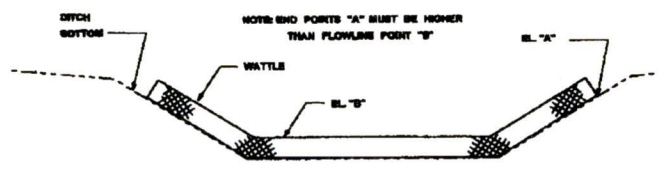

ELEVATION DETAIL

- NOTES:
1. MINIMUM RECOMMENDED PLACEMENT INTERVAL BETWEEN WATTLE DITCH CHECK IS UNLESS SHOWN OTHERWISE ON THE PLANS OR EROSION CONTROL PLAN APPROVED BY THE ENGINEER. SEE SPACING GUIDANCE ON SCD-4.
 2. ANCHORING WOOD STAKES SHALL BE SIZED, SPACED, DRIVEN, AND BE OF A MATERIAL THAT EFFECTIVELY SECURES THE CHECK. STAKE SPACING SHALL BE A MAXIMUM OF THREE FEET. ALL NON-DEGRADABLE MATERIALS SHALL BE REMOVED WHEN NO LONGER NEEDED.
 3. TRENCHING OF WATTLE MAY BE NECESSARY IF PONDING BECOMES EVIDENT.
 4. WATTLES SHOULD NOT BE USED IN HARD BOTTOM CHANNELS.

WATTLE DITCH CHECK SELECTION GUIDELINES

WATTLE DITCH CHECKS ARE APPROPRIATE FOR VELOCITY REDUCTION AND CONTROL OF SEDIMENT TRANSPORT UNDER LOW TO MEDIUM FLOW CONDITIONS.

MISSISSIPPI DEPARTMENT OF TRANSPORTATION	
DETAILS OF EROSION CONTROL	
WATTLE DITCH CHECK	
FILENAME: EROSION CONTROL/SCD-6/005	WORKING NUMBER: ECD-6
REVISION TEAM	DATE

14Jof14